

Henri Matisse

Tiles

2002

GENERAL DESCRIPTION

An ideal product for use in outdoor areas with high pedestrian traffic (sidewalks, squares, gardens, etc), even in damp climates.

WEIGHT

Positive flagstone 3,2 kg.
Negative flagstone 2,8 kg.

TECHNICAL DESCRIPTION

Made of two-layer concrete for outdoor use. Non-slip masonry surface with a raised pattern, composed of limy and siliceous aggregates, agglomerated with cement and marmoreal and siliceous sand.

The thickness of the print layer on the pieces is 18 mm. The mixture is blended with water repellents for minimum absorption, thus increasing its resistance to frost and ensuring optimum response to ageing.

These pieces are defined as concrete flagstones and are manufactured according to standard UNE 127023 EX 1999.

MECHANICAL CHARACTERISTICS

Bending resistance 4 Mpa
Resistance to wear and tear due to abrasion 21 mm
Water absorption 6 %
Slip resistance Unpolished masonry surface

LAYING INSTRUCTIONS

Place the flagstones on a layer of CEM II/A-P 32.5R cement mortar and 1/6 river sand (M-40, 30-50 mm thick), perfectly levelled, after first sprinkling pure cement over each flagstone. The adherence of the pieces is greatly improved if they are moistened prior to laying. Once the flagstones are in place, pour abundant water over them. Then vibrate the surface with a roller vibrator and clean the surface once again with abundant water. It is advisable to leave an expansion joint every 6 m that will penetrate the entire thickness of the key mortar and the base layer.

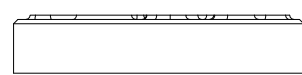

20

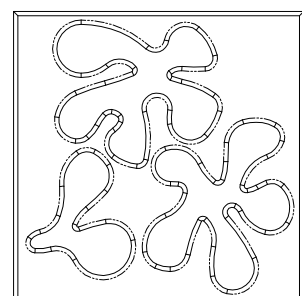

20

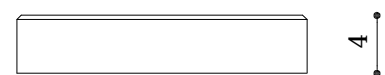

20

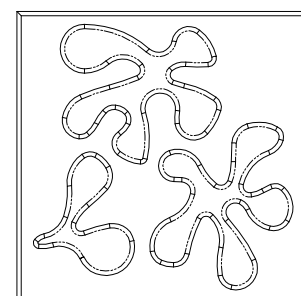

20

